

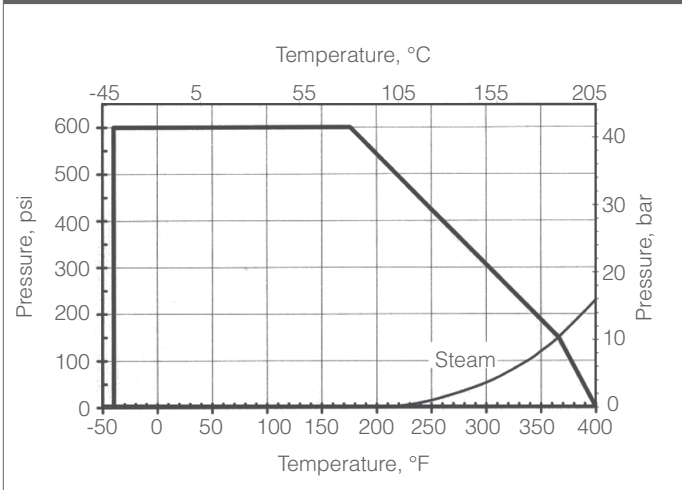

**Features**

- High integrity hot forged brass body
- Blow-out proof stem
- PTFE seals
- Adjustable PTFE packing with stem O-ring
- 100% tested
- Lever operated

**Series 666F Pressure-Temperature Ratings**



**Technical Specifications**

Valve Size Inches	Flow Coefficient, Cv
1/4"	6.3
3/8"	7.0
1/2"	19.0
3/4"	34.4
1"	50
1-1/4"	104
1-1/2"	268
2"	309
2-1/2"	629
3"	1018
4"	1622

**666FTTS Series Full Port Valve**

Quick Spec	
Product Scope	
Size Range	1/4" – 4", Full Port
Body Type	2-pc, End Entry with FNPT Ends
Pressure Rating	600 psi WOG (41 bar)
Temperature Range / WSP	-40°F thru 366°F / 150 psi Steam -40°C thru 186°C / 10,3 bar Steam
Body	Brass, Hot Forged
Trim	Brass, Chrome Plated
Seats	PTFE
Stem Packing / Seals	Adjustable PTFE / Buna-N O-Ring
Operator	Manual Lever, Non-Locking
Design Standards	
Threaded End Design	ASME B1.20.1
Testing Standards	
Pressure Testing	MSS-SP-110
Approvals	
FM (<=2")	UL
Classified UL EPH	c CSA <sub>us</sub>
NSF 61 (<=2")	

**Materials of Construction 600 Full Port Series**

Part	Material
Body	*Brass CuZn40Pb2
End Cap	*Brass CuZn40Pb2
Ball	*Brass CuZn40Pb2 Cr. Plated
Stem	**Brass CuZn39Pb3
Seat	PTFE
Thrust Washer, Stem	PTFE
O-Ring, Stem	NBR
Packing, Stem	PTFE
Gland	**Brass CuZn39Pb3
Nut, Gland	Steel, Plated
Handle	Steel, Plated
Nut, Handle	Steel, Plated

\* UNI EN 12165 CW617N (59Cu-40Zn-2Pb) equivalent to Hot Forging Brass UNS C37700 (60Cu-39Zn-2Pb)

\*\* UNI EN 12164 CW614N (58Cu-39Zn-3Pb) equivalent to Architectural Brass bar UNS C38500 (57Cu-40Zn-3Pb)

**Technical Specifications, metric**

Valve Size NPS	Flow Coefficient, Kv
DN8	5,4
DN12	6,0
DN15	16,3
DN20	29,6
DN25	43
DN32	89
DN40	231
DN50	266
DN65	541
DN80	875
DN100	1395

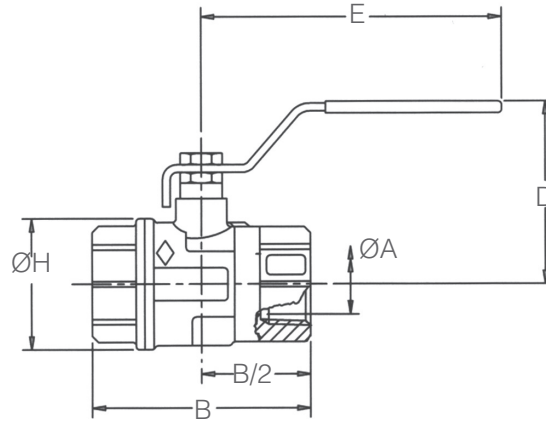

MD60007

Dimensions, Inches						
Valve Size	666FTTS Series					
Inches	ØA Port	B Length	D C/L Hand	E H and L	ØH Body OD	Wt (lbs)
1/4", 3/8"	0.39	2.02	1.7	3.9	0.90	0.33/0.30
1/2"	0.59	2.44	1.8	3.9	1.25	0.48
3/4"	0.79	2.71	2.3	4.8	1.53	0.79
1"	0.98	3.07	2.4	4.8	1.92	1.22
1-1/4"	1.26	3.42	3.0	6.0	2.32	2.14
1-1/2"	1.57	3.89	3.2	6.0	2.87	3.20
2"	1.95	4.33	3.7	6.4	3.38	4.08
2-1/2"	2.40	5.59	4.8	8.1	4.37	8.28
3"	2.87	6.45	5.2	8.1	5.35	13.0
4"	3.82	7.60	6.5	10.2	6.35	22.1

Dimensions, mm						
Valve Size	666FTTS Series					
NPS	ØA Port	B Length	D	E	ØH Body OD	Wt (kgs)
DN8, DN10	9,9	51,3	42	98	22,9	0,15/0,14
DN15	15,0	62,0	46	98	31,8	0,22
DN20	20,1	68,8	58	122	38,9	0,36
DN25	24,9	78,0	62	122	48,8	0,55
DN32	32,0	86,9	76	153	58,9	0,97
DN40	39,9	98,8	82	153	72,9	1,45
DN50	49,5	110,0	95	162	85,9	1,85
DN65	61,0	142,0	123	205	111,0	3,80
DN80	72,9	163,8	133	205	135,9	5,90
DN100	97,0	193,0	165	260	161,3	10,0

How to Order							
Body	Ball	Stem	Port	Packing	Seats	Ends	Size
6 = Brass	6 = Brass	6 = Brass	F = Full Port	T = PTFE	T = PTFE	S = FNPT	025
							038
							050
							075
							100
							125
							150
							200
							250
							300
							400

Sample Ordering Schematic

6	6	6	F	T	T	S	050
---	---	---	---	---	---	---	-----

## Marwin Valve

 A Division of Richards Industrials, 3170 Wasson Road, Cincinnati, OH 45209  
 toll free. 800.543.7311, local. 513.533.5600, fax. 513.871.0105  
 www.marwinvalve.com